



**LEOPARD**  
IMAGING

# LI-IMX901C-GM2B-086H



**Address:**

910 Auburn Ct  
Fremont, CA 94538  
USA



**Phone:**

+1 (408)263-0988

**Fax:**

+1 (408)217-1960



**Sales:**

[sales@leopardimaging.com](mailto:sales@leopardimaging.com)

**Support:**

[support@leopardimaging.com](mailto:support@leopardimaging.com)

## INTRODUCTION

The LI-IMX901C-GM2B-086H is a high resolution color GMSL2 camera. It is equipped with Sony Diagonal 22.67 mm (Type 1.4) CMOS 16MP global shutter image color sensor IMX901 and ADI GMSL2 serializer MAX96717. This camera outputs RAW image data.

## KEY FEATURES

Maximum Frame Rate	60 fps @ 3-exposure HDR
Sensor	Sony Diagonal 22.67 mm (Type 1.4) CMOS solid-state Image Sensor
Optical Format	1.4"
Shutter Type	Global shutter
Pixel Size	2.74 $\mu\text{m}$ x 2.74 $\mu\text{m}$
Color / Mono	Color
Output Format	12-bit / 10-bit RAW data
Resolution	8016 (H) x 2048 (V) (active pixels)
HDR (High Dynamic Range)	Supported
Serializer	ADI MAX96717
Connector	FAKRA Z TYPE
Operating Temp	TBD
Storage Temp	TBD
Power Supply Range	9 ~ 19 VDC
Power Consumption	TBD
Ingress Protection	N/A
Weight	~ 280 g

## APPLICATIONS

- FA
- ITS

## LENS SPECIFICATIONS

Focal Length	12 mm
Aperture, F/#	2.8 ~ 16
Field of View (FOV)	86° horizontal
IR Filter(on the holder)	650 nm IR cut filter
Lens Mount	C Mount



# DIMENSIONS

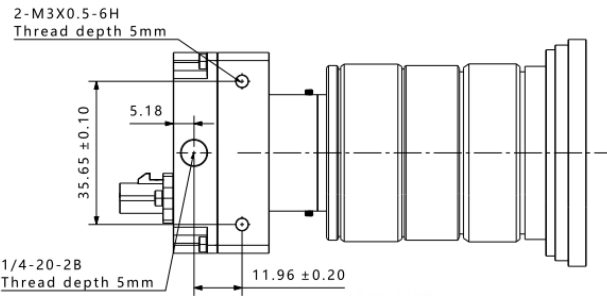
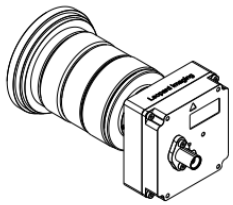
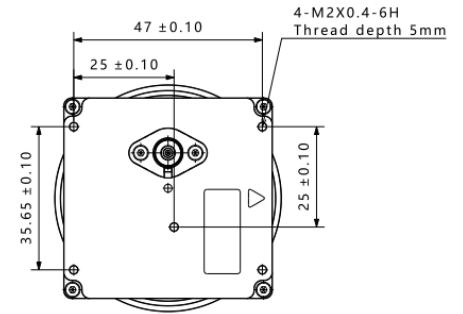
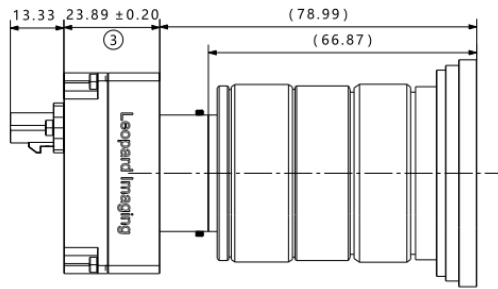
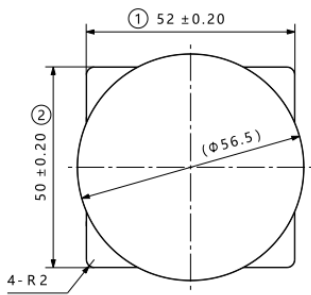

## NOTE:

- ⊗ marked are important sizes.
- Tolerances for others unmarked refer to the tolerance table.
- Unit: mm

TOLERANCE TABLE					
LENGTH TOLERANCE		CHAMFER TOLERANCE		ANGLE TOLERANCE	
Size X	Tolerance	Size X	Tolerance	Size X	Tolerance
0.5 < X ≤ 3	±0.1	0.5 < X ≤ 3	±0.2	X ≤ 10	±1°
3 < X ≤ 6	±0.1	3 < X ≤ 6	±0.5	10 < X ≤ 50	±30'
6 < X ≤ 30	±0.2	6 < X ≤ 30	±1	50 < X ≤ 120	±20'
30 < X ≤ 120	±0.3	X > 30	±2	120 < X ≤ 400	±10'
120 < X ≤ 400	±0.5			X > 400	±5'
400 < X ≤ 1000	±0.8				
X > 1000	±1.2				

● SYSTEM BLOCK DIAGRAM

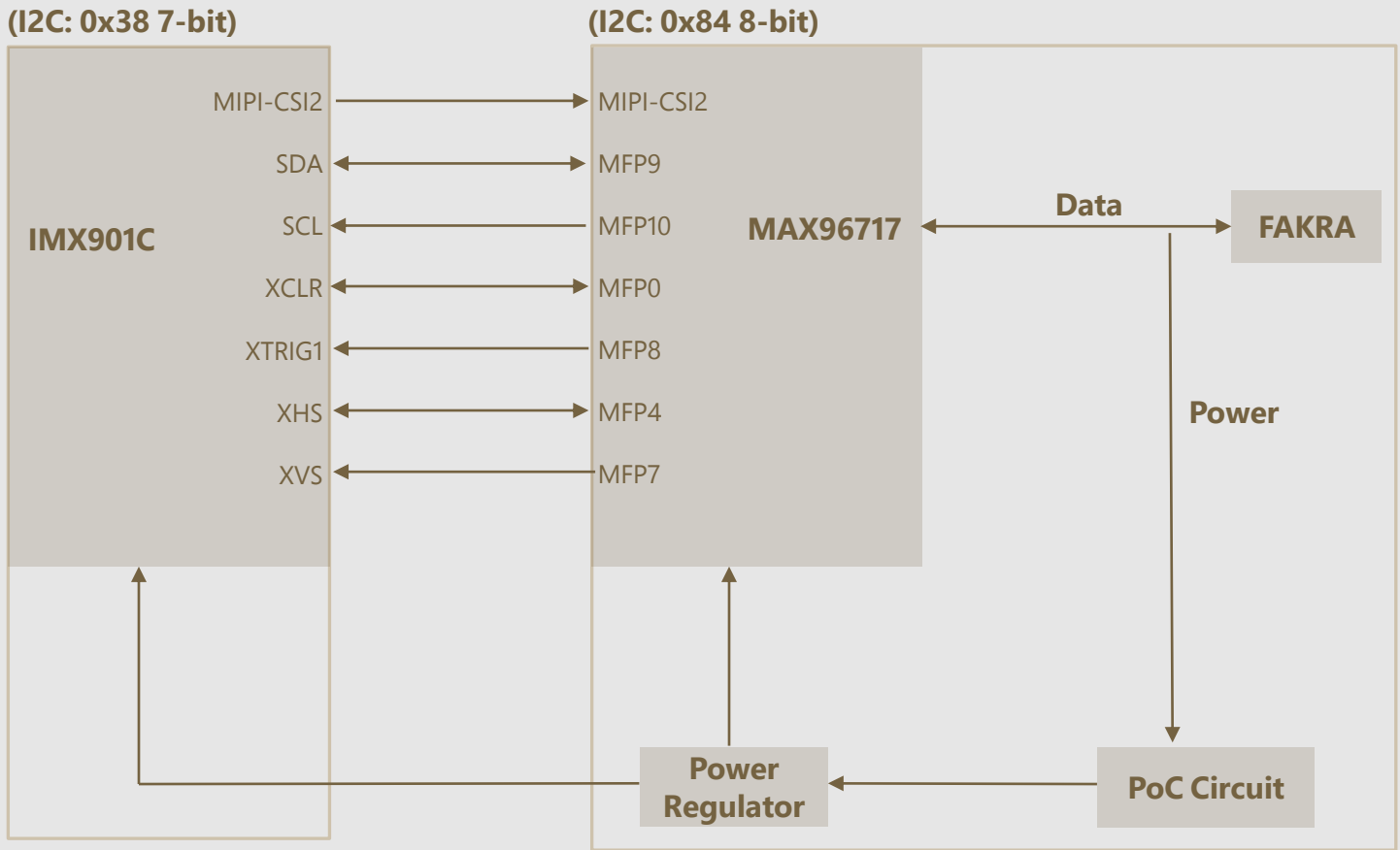

## ● REVISION HISTORY

Revision	Description	Release Date
0.1	Initial draft.	10 Nov 2025
0.2	Part number correction: Updated from LI-IMX901C-GM2B-076H to LI-IMX901C-GM2B-086H.	19 May 2026

910 Auburn Ct, Fremont, CA 94538, USA

Phone: +1-408-263-0988

Fax: +1-408-217-1960

Email: [sales@leopardimaging.com](mailto:sales@leopardimaging.com)

Website: [www.leopardimaging.com](http://www.leopardimaging.com)

