

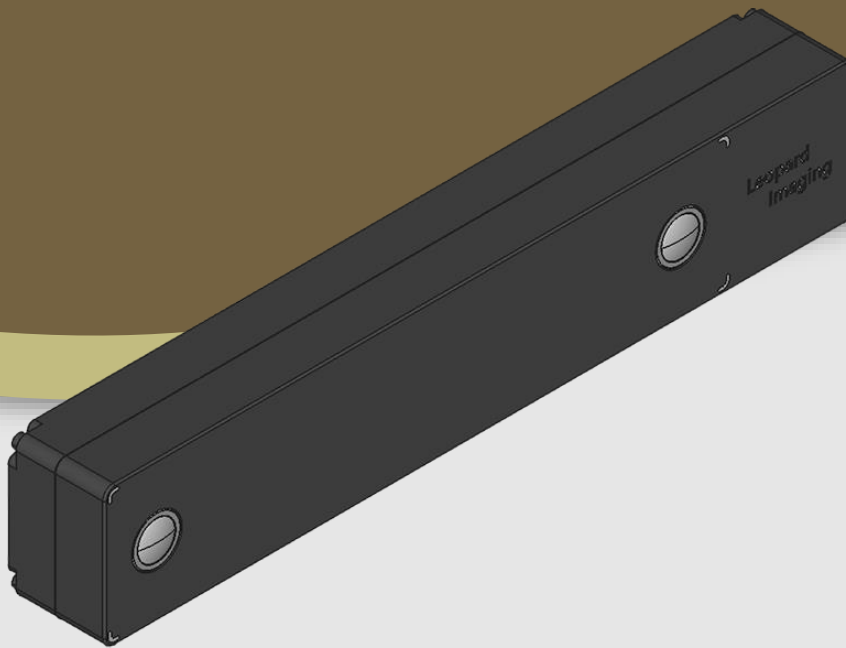

LEOPARD
IMAGING

LI-ASTRO-AR0234-ST150-10GigE-120H



Address:

910 Auburn Ct
Fremont, CA 94538
USA



Phone:

+1 (408)263-0988

Fax:

+1 (408)217-1960



Sales:

sales@leopardimaging.com

Support:

support@leopardimaging.com

TECHNICAL FEATURES

- Compatible with NVIDIA® Jetson AGX Orin™ / IGX Orin™ / Thor™ Developer Kit
- Lattice® CertusPro-NX FPGA
- AQrate® 10GB Ethernet PHY Transceiver
- Sensor: ON Semiconductor CMOS Image Color Sensor AR0234CS (QYT: 2)
- Shutter Type: Global Shutter
- Resolution: 1920 (H) x 1200 (V) (active pixels)
- Frame Rate: TBD
- Output Format: 10-bit RAW
- Focus distance: 1 m
- Working Mode: Master mode / Trigger mode
- IMU (Inertial Measurement Unit): BMI088
- Interface: 10G Ethernet
- Connector: RJ45
- Power Supply: 12 VDC
- Power Consumption: TBD
- Operating temperature: TBD
- Storage temperature: TBD
- Weight: TBD
- Allows customization

Applications

- In Cabin Automotive
 - ◆ Gesture Recognition
 - ◆ Iris Scanning
 - ◆ Head Roll
 - ◆ Eye Tracking
 - ◆ Machine Vision

LENS SPECIFICATIONS

Focal Length	2.8 mm
Aperture, F/#	2.1
Field of View (FOV)	120° horizontal
Relative Illumination	> 40.0%
IR Filter	650 nm IR cut Filter
Lens Mount	M12 x P0.5

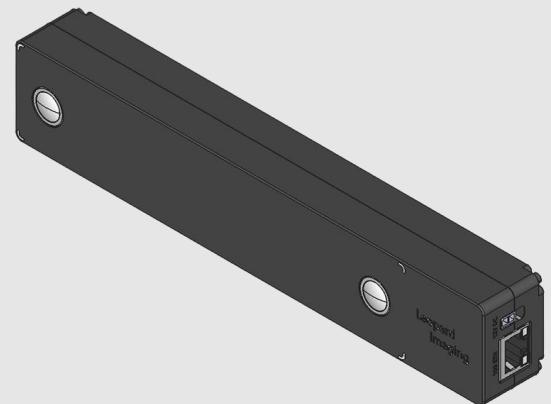
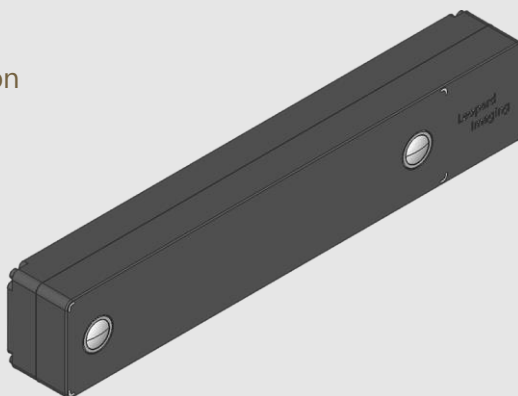

BOM

#	Items	QTY
1	LI-ASTRO-AR0234-ST150-10GigE-120H	1
2	CAT-8 10G Ethernet Cable	1
3	12 VDC Power Supply + adapter cable (Only for test)	1

Typical Connection

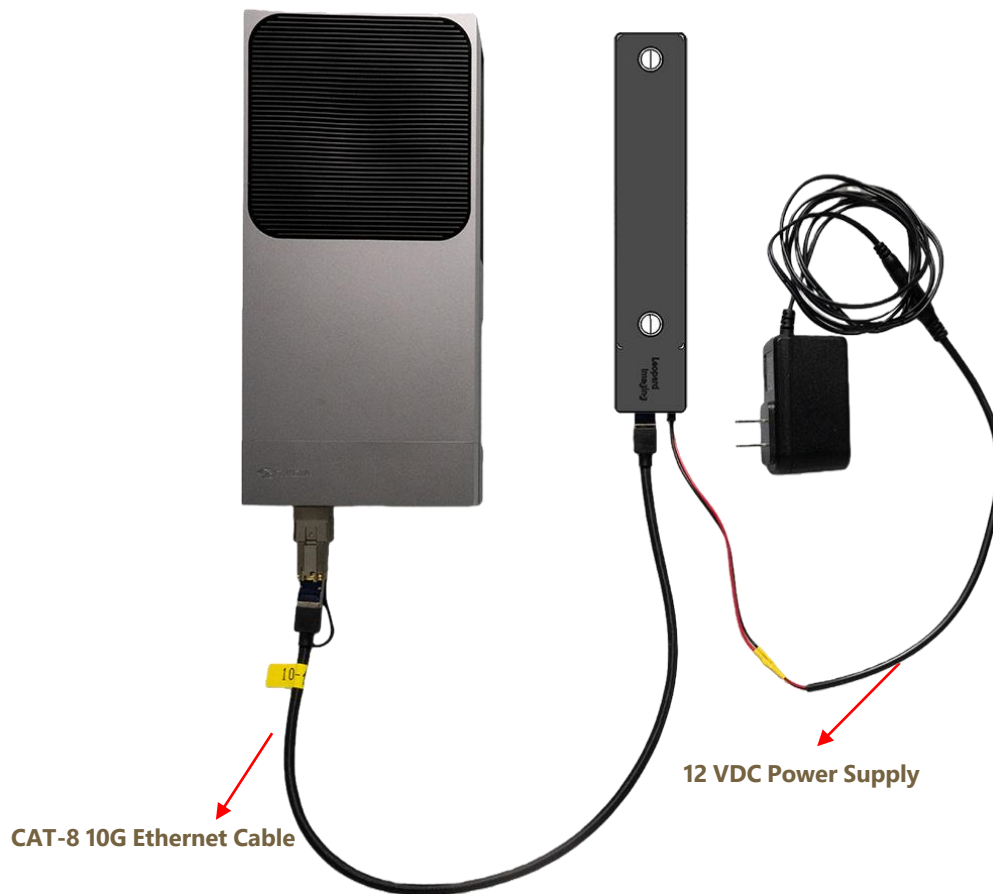

Nvidia® Jetson IGX Orin / AGX Orin™ Developer Kit is **NOT** included.

DIMENSIONS

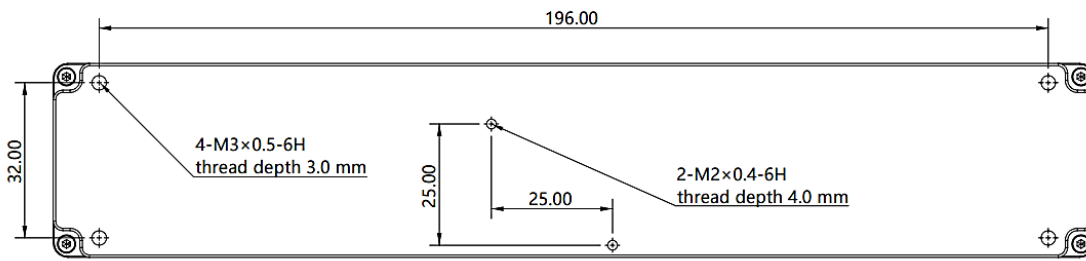
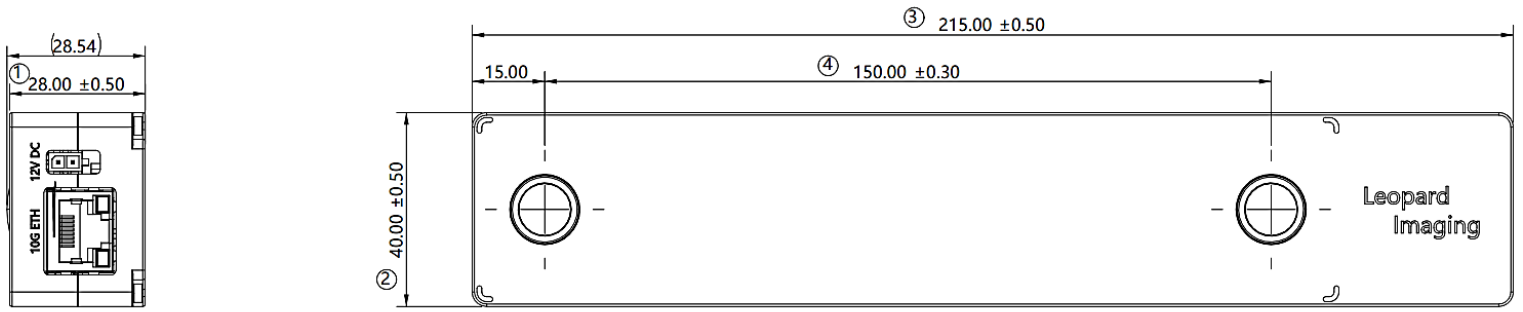

NOTE:

- Other unmarked tolerances refer to the tolerance table.
- ⊗ marked are important sizes.
- All materials are compliant with RoHS requirements.
- Unit: mm

TOLERANCE TABLE					
LENGTH TOLERANCE		CHAMFER TOLERANCE		ANGLE TOLERANCE	
Size X	Tolerance	Size X	Tolerance	Size X	Tolerance
0.5 < X ≤ 3	±0.1	0.5 < X ≤ 3	±0.2	X ≤ 10	±1°
3 < X ≤ 6	±0.1	3 < X ≤ 6	±0.5	10 < X ≤ 50	±30'
6 < X ≤ 30	±0.2	6 < X ≤ 30	±1	50 < X ≤ 120	±20'
30 < X ≤ 120	±0.3	X > 30	±2	120 < X ≤ 400	±10'
120 < X ≤ 400	±0.5			X > 400	±5'
400 < X ≤ 1000	±0.8				
X > 1000	±1.2				

● RJ45 10GB Ethernet

- Part#: 7499811420
- Connector Type: RJ45
- Orientation: 90° Angle (Right)
- Number of Cores per Jack: 8

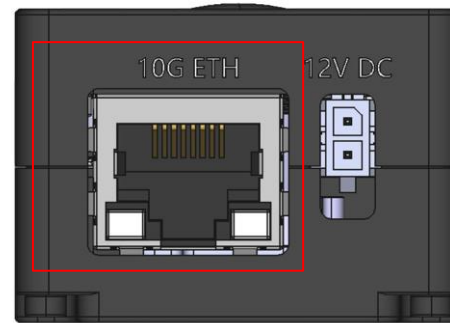

● External 12 VDC Power Supply

- Part#: 0430450200
- Number of Positions: 2

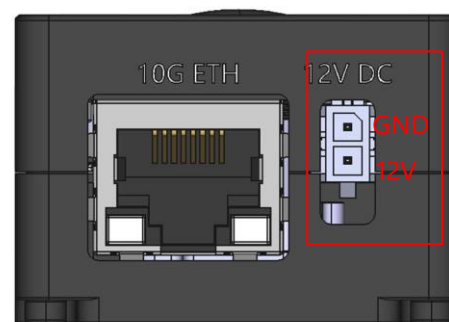

- REVISION HISTORY

Revision	Description	Release Date
0.1	Initial draft.	14 Apr 2026

910 Auburn Ct, Fremont, CA 94538, USA

Phone: +1-408-263-0988

Fax: +1-408-217-1960

Email: sales@leopardimaging.com

Website: www.leopardimaging.com

