



**LEOPARD**  
IMAGING

# LI-ISX028-GM2B-xxxH



**Address:**

910 Auburn Ct  
Fremont, CA 94538  
USA



**Phone:**

+1 (408)263-0988

**Fax:**

+1 (408)217-1960



**Sales:**

[sales@leopardimaging.com](mailto:sales@leopardimaging.com)

**Support:**

[support@leopardimaging.com](mailto:support@leopardimaging.com)

## INTRODUCTION

The LI-ISX028-GM2B-xxxH is equipped with Sony diagonal 9.30 mm 8.39MP CMOS color sensor ISX028 and Maxim GMSL2 serializer MAX96717. This camera outputs RAW data.

## SPECIFICATIONS

Sensor	Diagonal 9.30 mm 8.39MP CMOS Sensor ISX028
Optical Format	1/1.72"
Resolution	3840 (H) x 2160 (V) (based on ISP binary)
Pixel Size	2.1 x 2.1 $\mu$ m
Color / Mono	Color sensor
Output Format	8-bit YUV / 10-bit YUV / 8-bit RAW / 10-bit RAW
Frame Rate	30 fps @ 3840 x 2160
HDR (High Dynamic Range)	Supported
LFM (LED Flicker Mitigation)	Supported
Lens	FOV H 30° / 70° / 120°
Serializer	Maxim MAX96717
Connector	FAKRA Z TYPE
Power Supply Range	9 ~ 19 VDC
IP Rating	030H: TBD 070H: IP67 120H: IP69K
Power Consumption	~ 114 mA @ 12 VDC (3840 x 2160 @ 15 fps)
Operating Temp	-40°C ~ +85°C
Storage Temp	-40°C ~ +85°C
Weight	~ 50 g

## APPLICATIONS

- Automotive
  - ◆ High Resolution Front Viewing
  - ◆ Machine Vision
  - ◆ Autonomous Driving
  - ◆ Assisted Driving
  - ◆ Digital Video Recording

## CABLE CONNECTOR

- Housing Connector: FAKRA Z Type
- Cable Length: 3 meters



030H



070H



120H



## DIMENSIONS: LI-ISX028-GM2B-030H

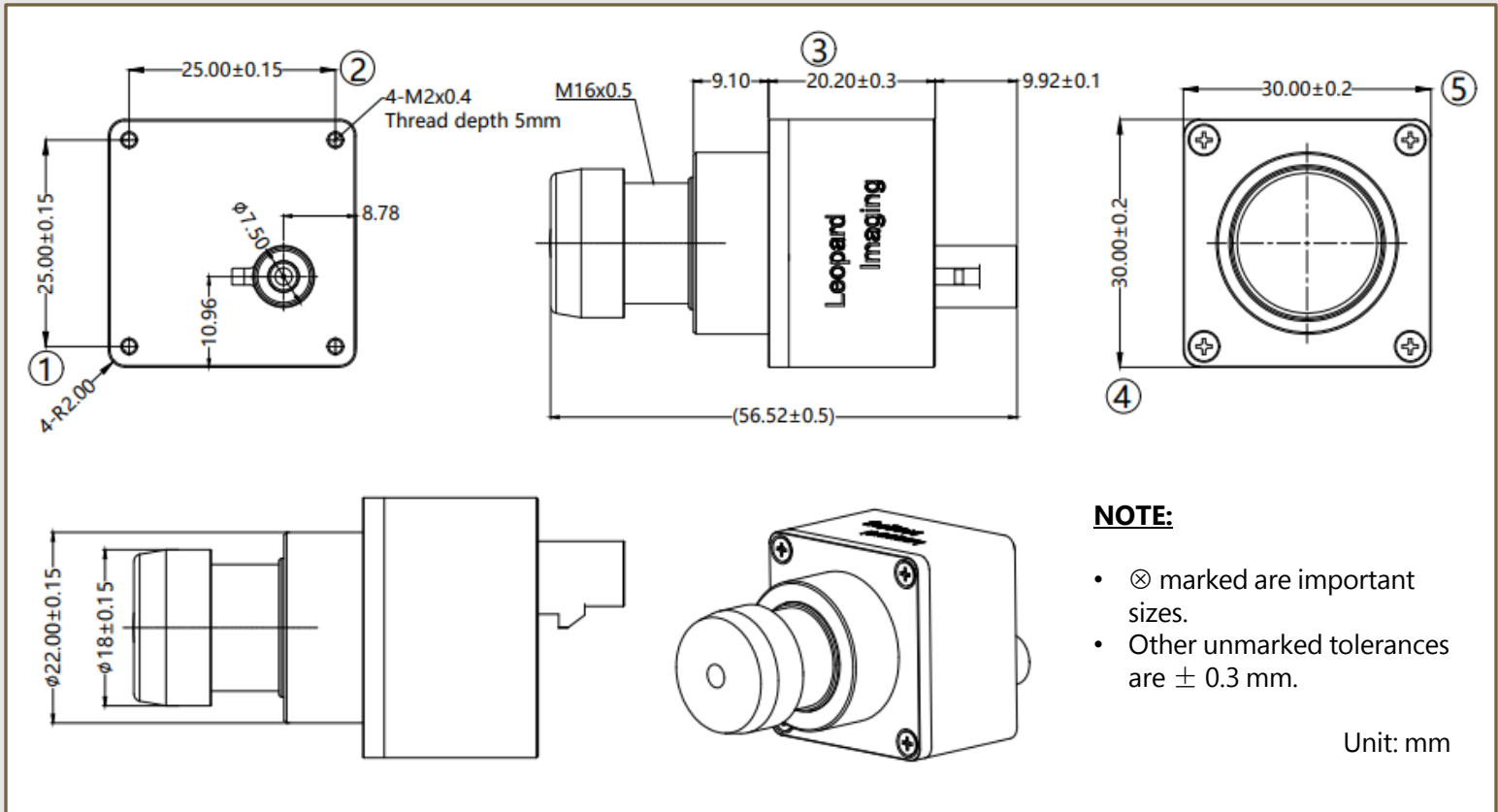

### NOTE:

- $\otimes$  marked are important sizes.
- Other unmarked tolerances are  $\pm 0.3$  mm.

Unit: mm

## DIMENSIONS: LI-ISX028-GM2B-070H

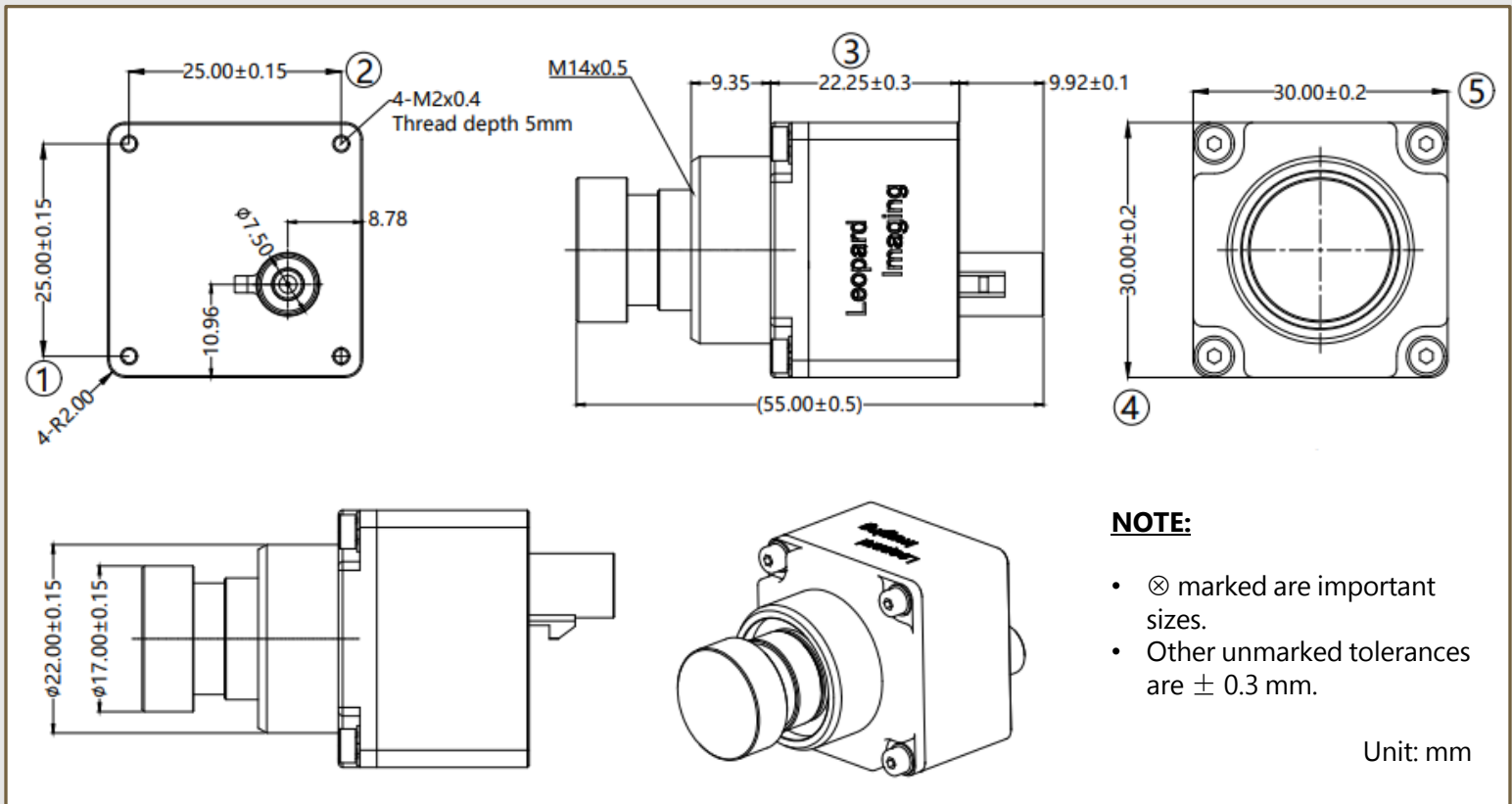

### NOTE:

- $\otimes$  marked are important sizes.
- Other unmarked tolerances are  $\pm 0.3$  mm.

Unit: mm

## DIMENSIONS: LI-ISX028-GM2B-120H

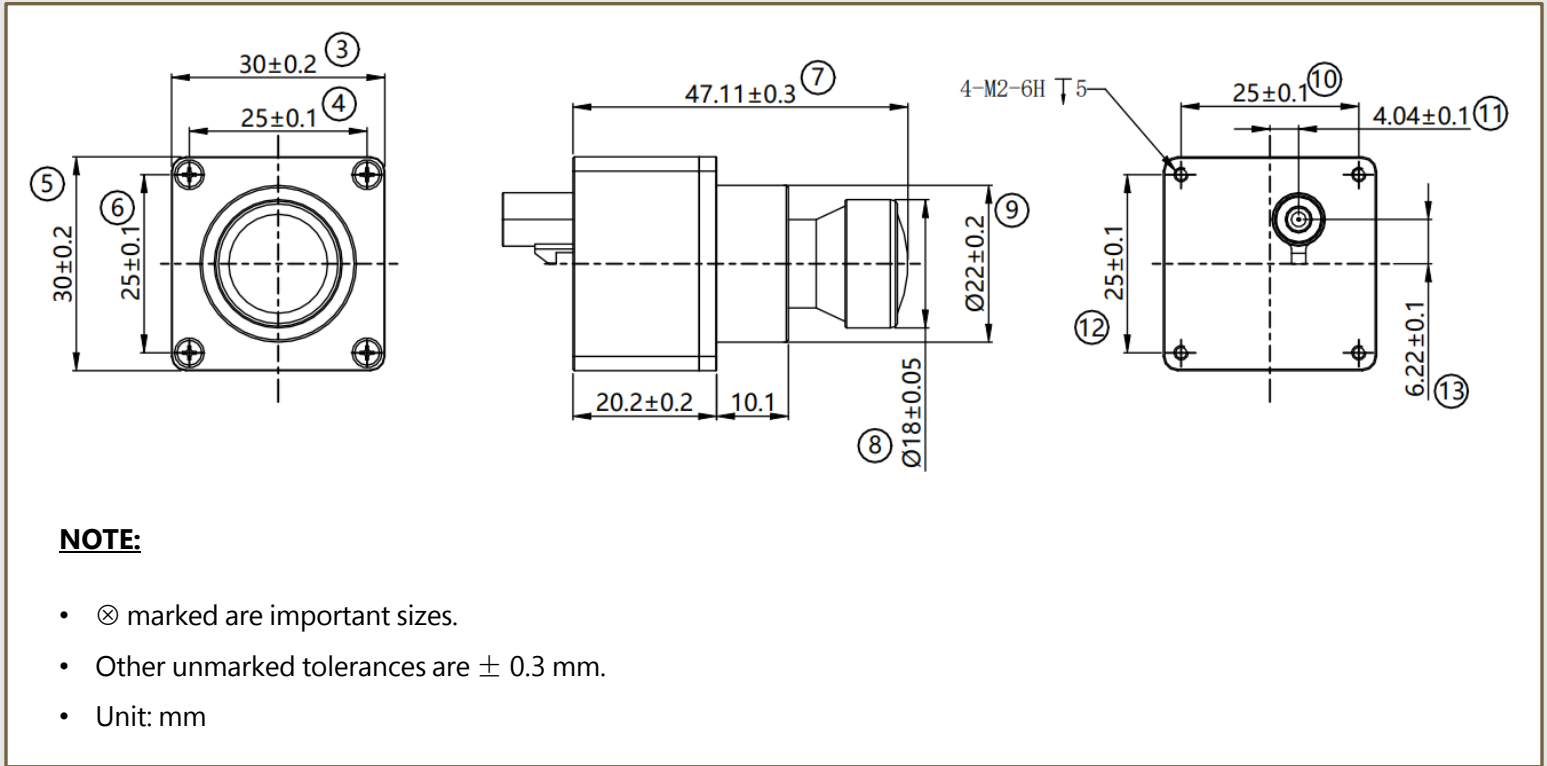

## IMAGE ORIENTATION



## ORDERING INFORMATION

**NOTE:**

xxxH - 030H: FOV H 30°    xxxH - 070H: FOV H 70°    xxxH - 120H: FOV H 120°

LI-ISX028-GM2B-030H	LI-ISX028-GM2B-070H
	
Lens EFL: 15.3 mm	Lens EFL: $6.7 \pm 0.15$ mm
Aperture, F/#: 1.65	Aperture, F/#: $1.65 \pm 0.15$
Field of View (FOV): 30.0° horizontal	Field of View (FOV): 70.0° horizontal
IR Filter: 660 nm IR cut filter	IR Filter: 660 nm IR cut filter
Mount: M16	Mount: M14

LI-ISX028-GM2B-120H

Lens EFL: $3.9 \text{ mm} \pm 2\%$
Aperture, F/#: $1.6 \pm 5\%$
Field of View (FOV): 120° horizontal
IR Filter: 650 nm IR cut filter
Mount: M12

# SYSTEM BLOCK DIAGRAM

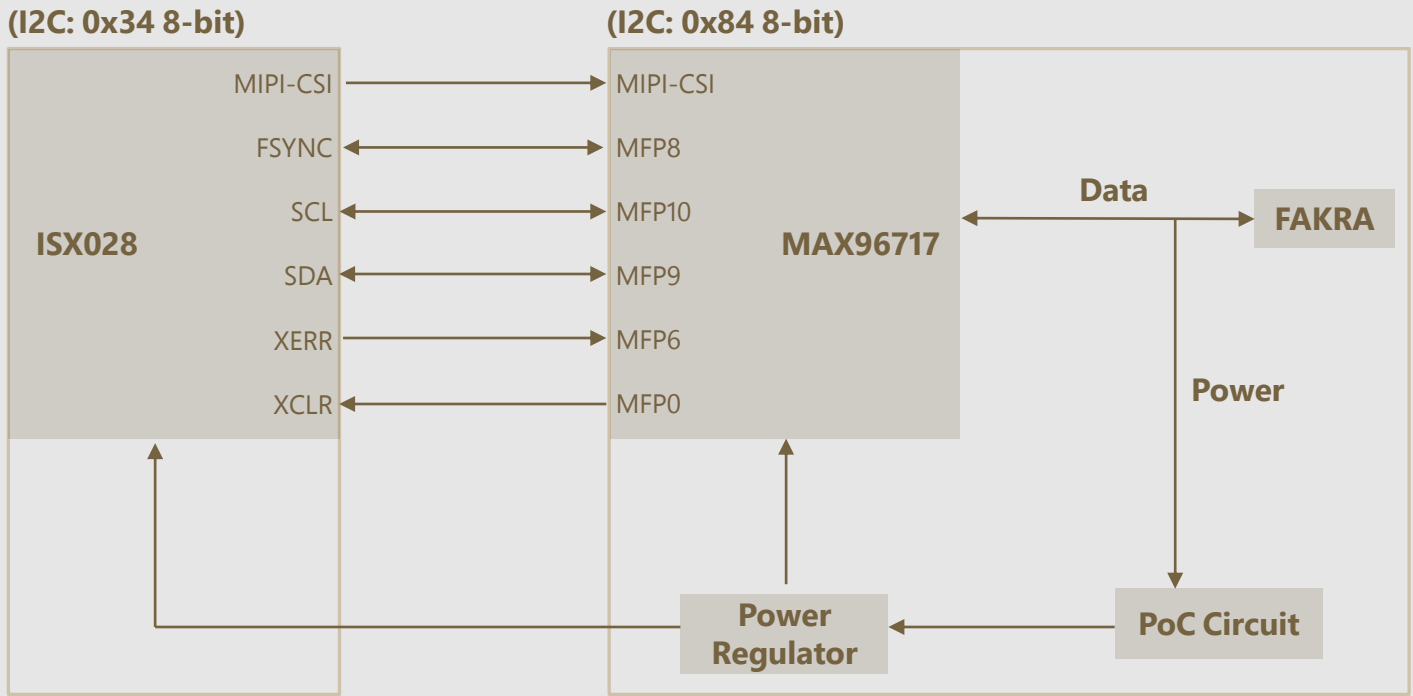

## ● REVISION HISTORY

Revision	Description	Release Date
0.1	Initial draft.	28 Sep 2025
0.2	Changed 120H LENS info.	28 Jan 2026
0.3	<ol style="list-style-type: none"><li>1. Updated Operating Temp and Storage Temp.</li><li>2. Updated Frame Rate.</li><li>3. Deleted USB3.0 KIT page.</li><li>4. Changed image orientation from reverse to forward.</li></ol>	13 Mar 2026

910 Auburn Ct, Fremont, CA 94538, USA

Phone: +1-408-263-0988

Fax: +1-408-217-1960

Email: [sales@leopardimaging.com](mailto:sales@leopardimaging.com)

Website: [www.leopardimaging.com](http://www.leopardimaging.com)

